

Geelong Waterfront Campus



LEVEL 1

- Cafe 1
- Carpark (special permit required) 2
- Computer Lab—D1.108 3
- Deakin University Student Association (DUSA4U) 6
- Events and Community Relations (Marketing Division) 5
- Faculty of Health, Medicine, Nursing and Behavioural Sciences 4
- Mature Age Room (DUSA4U) 7
- Muslim Prayer Room 9
- Student Recreation Room (DUSA4U) 8



main entry	unisex accessible toilet	male shower
vehicle entry	platform lift to level one only	female shower
accessible parking	Restricted access by prior arrangement—Contact: Security 222 or 5227 8222	stairs
reserved accessible car park	bicycle rack	baby change facilities
female accessible toilet	lift	public telephone
male accessible toilet	female toilet	ATM automatic teller machine
	male toilet	Deakin Card reload station

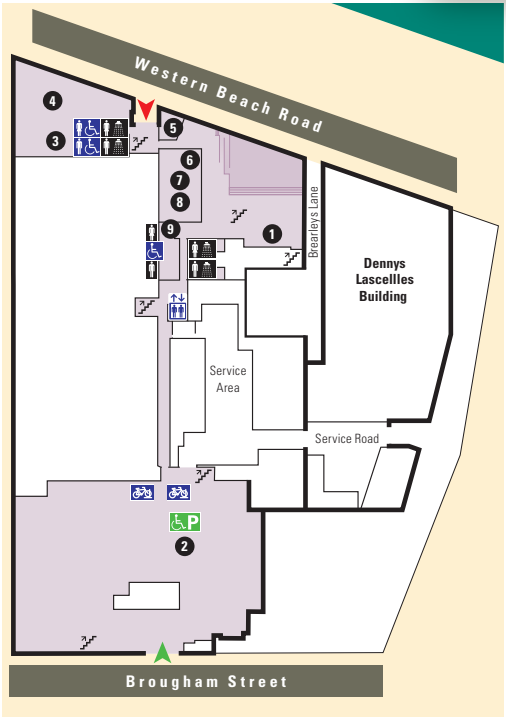

- Books4U Bookshop (DUSA4U)—D2.159 21
- Cashier 22
- Committee for Geelong—D2.210 24
- Costa Foyer** 15
- Costa Hall** 16
- Deakin Central (DSA) 27
- Division of Student Life (DSL) 26
- Faculty of Health, Medicine, Nursing and Behavioural Sciences Student Centre 12
- Gallery—D2.200 28
- Institute of Teaching and Learning (ITL) 20
- Information Technology Services Division (ITSD) 17
- Knowledge Media Division (KMD) 23
- Breast feeding facility/Sick bay, Health Service 25
- Lecture Theatres**
- D2.194 18 D2.193 (Percy Baxter) 19
- Meeting Rooms**
- D2.202 10 D2.218 11
- Tutorial Rooms**
- D2.211 14 D2.212 13

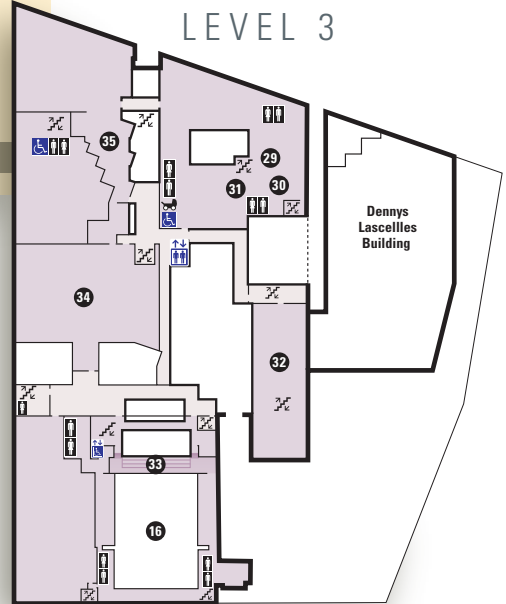

- Costa Hall** 16
- Costa Theatre** 33
- Governance Unit Reception 31
- Library Technical Services 34
- Main Library** 35
- School of Nursing 32
- The Chancellery 29
- University Solicitor's Office 30



- Costa Theatre**
- Deakin International Education Abroad 38
- Governance Unit 31
- Internal Audit 37
- Planning Unit 36
- School of Architecture and Building 40
- School of Health and Social Development 39
- Occupational Science and Therapy
- Social Work
- Computer Labs**
- D4.177 47 D4.179 46
- Meeting Rooms**
- D4.203 48 D4.205 49
- Tutorial Rooms**
- D4.105 45 D4.106 44 D4.107 43
- D4.108 42 D4.109 41