

Geelong Waterfront campus

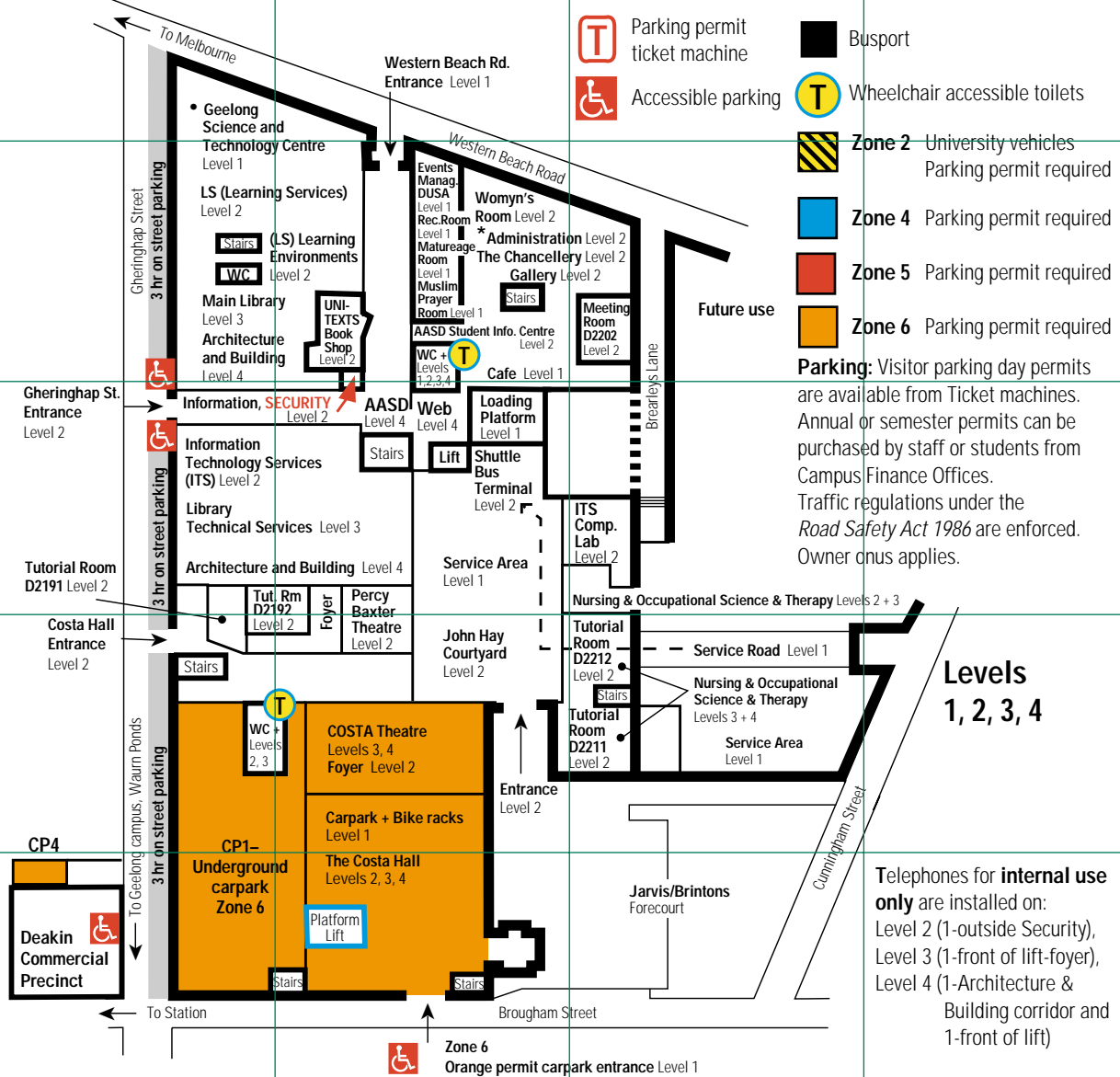

Parking: Visitor parking day permits are available from Ticket machines. Annual or semester permits can be purchased by staff or students from Campus Finance Offices. Traffic regulations under the *Road Safety Act 1986* are enforced. Owner onus applies.

Telephones for **internal use only** are installed on:
 Level 2 (1-outside Security),
 Level 3 (1-front of lift-foyer),
 Level 4 (1-Architecture & Building corridor and 1-front of lift)

- Level 1 Entrance—Western Beach Rd.:** • Geelong Science and Technology Centre (GSAT); Deakin University Student Association (DUSA); Events Management Office (B&G); Cafeteria; Womyn's Room; Student Recreation Room; Matureage Room; Muslim Prayer Room; WC + Showers—Change Room; Service area; Loading platform; Special permit carpark; Bike racks
- Level 2 Two Entrances—Gheringhp St.:** Learning Services (LS); Committee for Geelong; Learning Environments (LS); Information Technology Services (ITS); Student Information Centre (AASD)—8.45am to 1.00pm; UNITEXTS Bookshop; Meeting Room—D2202 Percy Baxter Lecture Theatre—D2193 Gallery—D2200; Security; Shuttle Bus Terminal; Tutorial Rooms—D2191, D2192, D2211, D2212 John Hay Courtyard—D2215 Sick bay/Breast feeding facility (next door to cashier) *Administration: *Cashier—9am to 12.30pm; *Student Life; *Conference Management Services
- Level 3** The Chancellery; Main Library; Technical Services; School of Nursing
- Level 4 Architecture and Building;** Academic Administrative Services Division (AASD); Academic Administration and Graduations; Planning Office; Internal Audit;
- COSTA Theatre:** Levels 3, 4 (foyer Level 2)
- The COSTA Hall:** Levels 2, 3, 4—GPAC-Box Office Level 2
- Deakin Commercial Precinct:**
- Level 1 Basement—**Deakin Archives
- Level 2** Ford Discovery Centre; Callista Software Services
- Level 3** Ford Discovery Centre; Callista Software Services
- Level 4** Callista Software Services

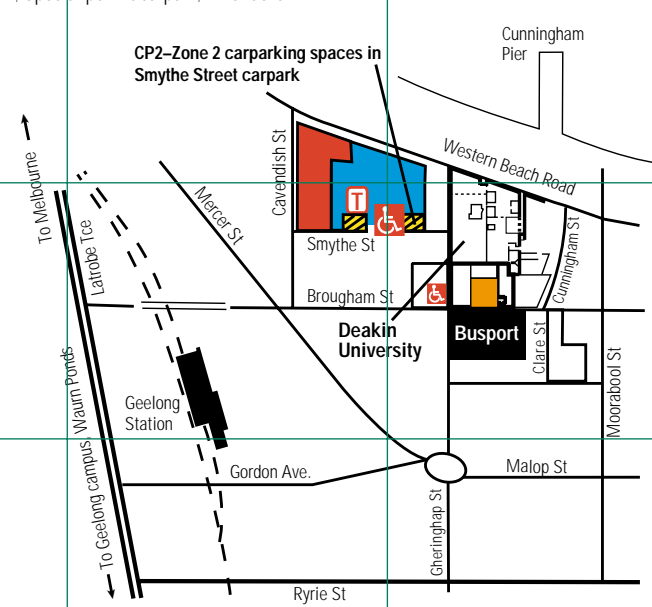

accurate as at 11/11/2002—please e-mail any changes to deva@deakin.edu.au