

Geelong Campus Library—B Level

Building 2

- Main Entrance
- Quiet Study Rooms
- Library Workstations and Computer Laboratory
- Reference, Law, Audiovisual and Current Journal Collections are kept on this level
- Library Services including Information, Loans, Document Delivery and Catalogues

Library Tour checkpoints

- 1 Information Desk
- 2 Loans Desk
- 3 Self checkout
- 4 Reference Collection
- 5 Current Journals
- 6 Photocopiers
- 7 Intercampus Collection Point
- 10 Library Workstations
- 11 ITS Lab
- Staff Areas
- Lift
- Photocopiers
- Toilets—Male/Female Wheelchair Access

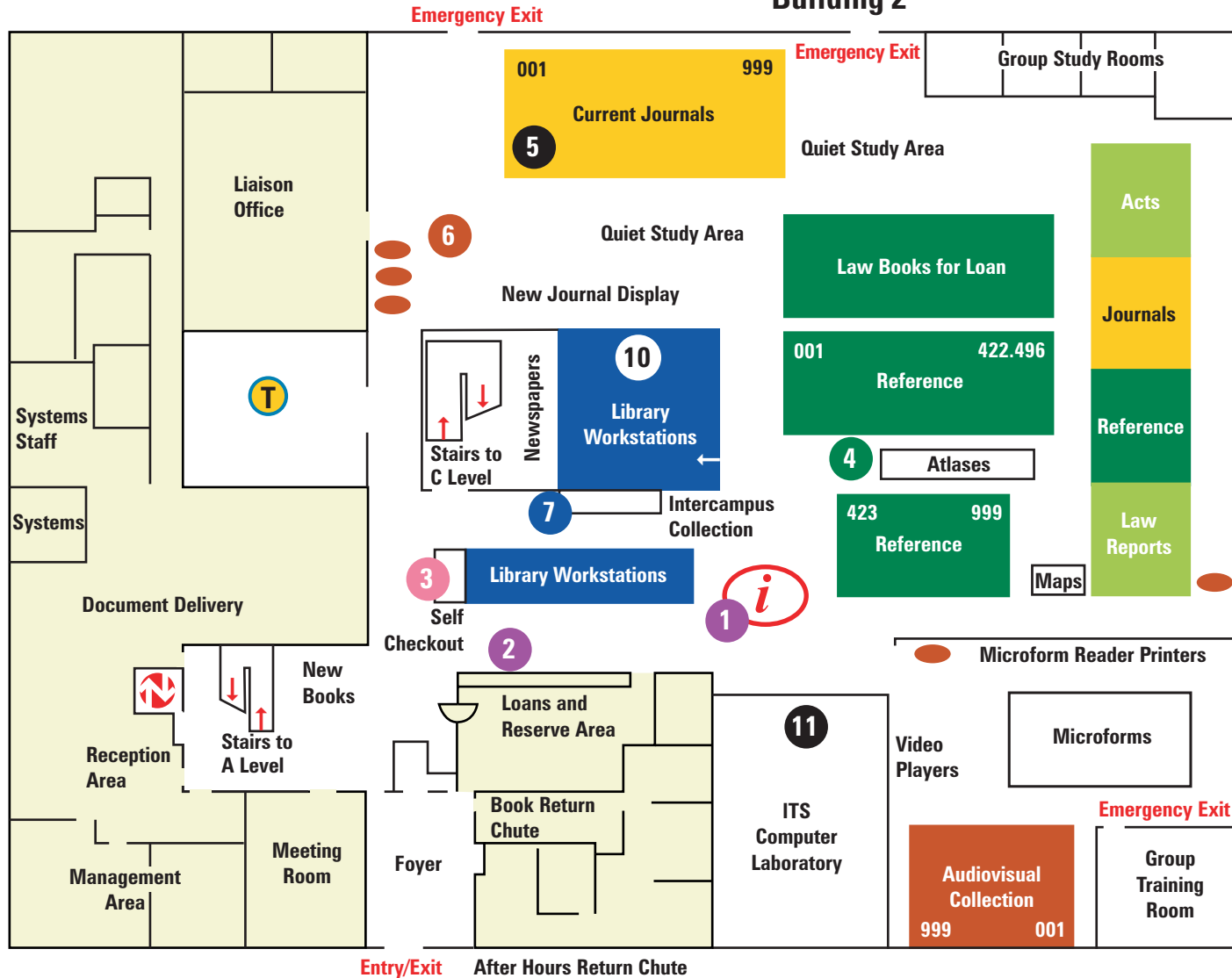

(accurate as at 20/2/2003)

Entry/Exit After Hours Return Chute